

Excess Flow Valves

15EF Series: 15,000 psig (1034 bar)

20EF Series: 20,000 psig (1379 bar)

60EF Series: 60,000 psig (4137 bar)

Fittings
Tubing
Quick Couplings
Line Filters
Valves
Sour Service Products
Subsea Valves
Tools and Installation Instructions
Technical Information
Part Number Crossover Charts



Contents

Features	E-66
Standard Materials of Construction	E-66
Ordering Information and Dimensions	E-66
Ordering Number Description	E-67

Fittings
Tubing
Quick Couplings
Line Filters
Valves
Sour Service Products
Subsea Valves
Tools and Installation Instructions
Technical Information
Part Number Crossover Charts

Features

- ⦿ Working temperature range:
 - 15EF Series (NPT ends): -110°F to 400°F (-79°C to 204°C)
 - 15EF Series (DFF ends): -110°F to 800°F (-79°C to 427°C)
 - 20EF and 60EF Series: -110°F to 1200°F (-79°C to 649°C)
- ⦿ Protect pressure gauges and pressure instruments from sudden surges in flow or venting in the event of line failure
- ⦿ Equalize the pressure across the ball, and the ball will drop and reset automatically
- ⦿ The valve must be installed in vertical position with arrow on valve body pointing up
- ⦿ Valve body made of high tensile 316 stainless steel for maximum wear and corrosion resistance
- ⦿ Optional materials of cover and ball for longer life

Standard Materials of Construction

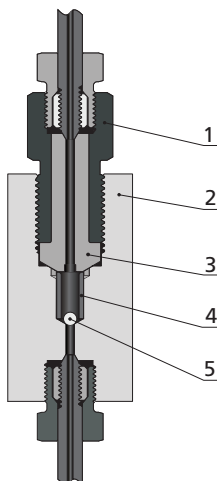

Item	Component	Material Grade
1	Cover Gland	316 SS
2	<i>Valve Body</i>	<i>316 SS</i>
3	Cover	316 SS
4	Sleeve	316 SS
5	Ball	<i>Stainless Steel</i>
	Lubricant	Molybdenum Disulfide/Fluorinated-based

Wetted components listed in italics.

Ordering Information and Dimensions

15EF Series (NPT ends)

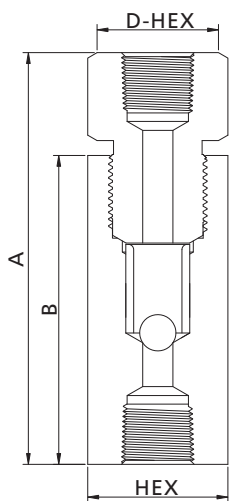

15EF Series (DFF ends)

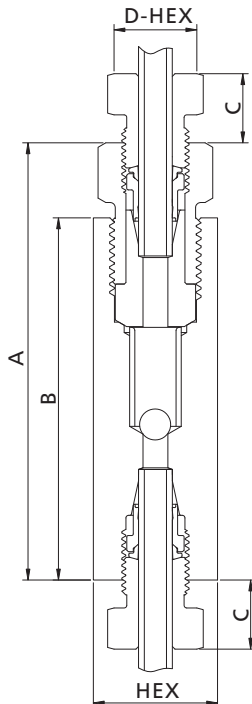

20EF and 60EF Series

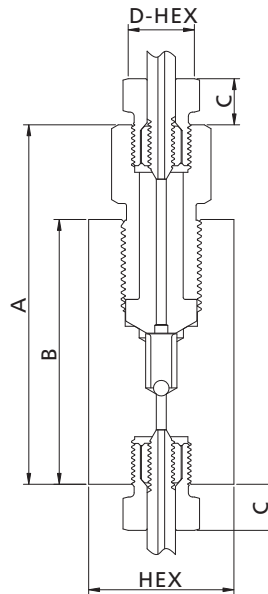

Fittings
 Tubing
 Quick Couplings
 Line Filters
 Valves
 Sour Service Products
 Subsea Valves
 Tools and Installation Instructions
 Technical Information
 Part Number Crossover Charts

Ordering Number	Connection	Orifice in. (mm)	Dimensions, in. (mm)					Working Pressure psig (bar)
			A	B	C	D - HEX	HEX	
15EFSS-DFF4	DFF4	0.188 (4.78)	3.35 (85)	2.72 (69.2)	0.52 (13.3)	0.63 (16.0)	0.81 (20.6)	15,000 (1034)
15EFSS-DFF6	DFF6	0.250 (6.35)	3.72 (94.6)	3.13 (79.6)	0.53 (13.5)	0.75 (19.1)	1.00 (25.4)	15,000 (1034)
15EFSS-DFF8	DFF8	0.375 (9.53)	4.41 (112.0)	3.68 (93.5)	0.60 (15.3)	0.93 (23.6)	1.38 (35.1)	15,000 (1034)
15EFSS-FNS4	FNS4	0.12 (3.05)	3.30 (83.8)	2.38 (60.3)	/	0.94 (23.8)	0.94 (23.8)	15,000 (1034)
15EFSS-FNS6	FNS6	0.22 (5.59)	3.95 (100.3)	2.88 (73.2)	/	1.13 (28.6)	1.13 (28.6)	15,000 (1034)
15EFSS-FNS8	FNS8	0.36 (9.12)	5.07 (128.9)	3.88 (98.6)	/	1.38 (34.9)	1.38 (34.9)	15,000 (1034)
20EFSS-MF4	MF4	0.125 (3.18)	2.94 (74.7)	2.50 (63.5)	0.38 (9.7)	0.50 (12.7)	0.81 (20.6)	20,000 (1379)
20EFSS-MF6	MF6	0.218 (5.54)	3.12 (79.3)	2.62 (66.6)	0.44 (11.2)	0.62 (15.8)	1.00 (25.4)	20,000 (1379)
20EFSS-MF9	MF9	0.359 (9.12)	4.18 (106.2)	3.50 (88.9)	0.55 (14.0)	0.94 (23.9)	1.38 (35.1)	20,000 (1379)
20EFSS-MF12	MF12	0.516 (13.11)	5.50 (139.7)	4.75 (120.7)	0.60 (15.2)	1.19 (30.2)	1.75 (44.5)	20,000 (1379)
20EFSS-MF16	MF16	0.688 (17.48)	6.91 (175.6)	5.75 (146.1)	0.74 (18.8)	1.38 (35.1)	2.12 (53.9)	20,000 (1379)
60EFSS-HF4	HF4	0.094 (2.39)	3.38 (85.9)	2.50 (63.5)	0.47 (11.9)	0.63 (16.0)	1.18 (30.0)	60,000 (4137)
60EFSS-HF6	HF6	0.125 (3.18)	3.86 (98.1)	2.80 (71.1)	0.61 (15.5)	0.81 (20.6)	1.18 (30.0)	60,000 (4137)
60EFSS-HF9	HF9	0.187 (4.75)	4.62 (117.4)	3.38 (85.9)	0.95 (24.1)	1.19 (30.16)	1.50 (38.1)	60,000 (4137)

NOTE: All dimensions are for reference only and are subject to change. For dimensions not shown above, please contact FITOK Group or our authorized distributors.

Ordering Number Description

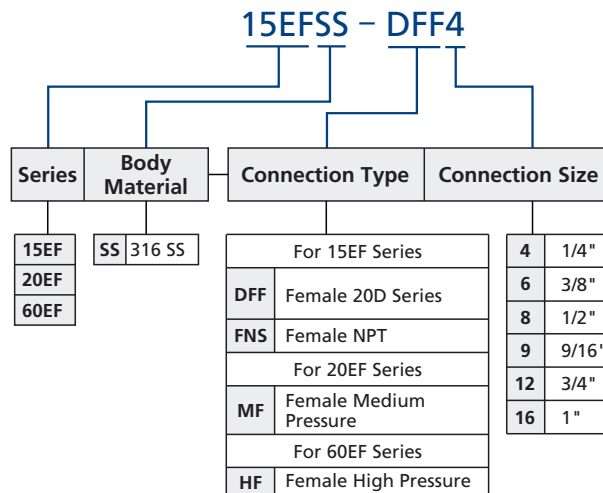

- NOTES: 1. For more details regarding 20D Series and Medium/High Pressure connections, please see **Connection Information** on I-02.
 2. "Ordering Number Description" is a reference to understand the combination rules of FITOK product part number. Not all combinations are available.

Fittings

Tubing

Quick Couplings

Line Filters

Valves

Sour Service Products

Subsea Valves

Tools and Installation Instructions

Technical Information

Part Number Crossover Charts